

| REVISION TABLE | | | | | |
|----------------|------|-------------|--------|----------|--------|
| REV | ECN# | DESCRIPTION | REV BY | APPROVED | DATE |
| L | --- | --- | JRM | MPW | 9-1-11 |

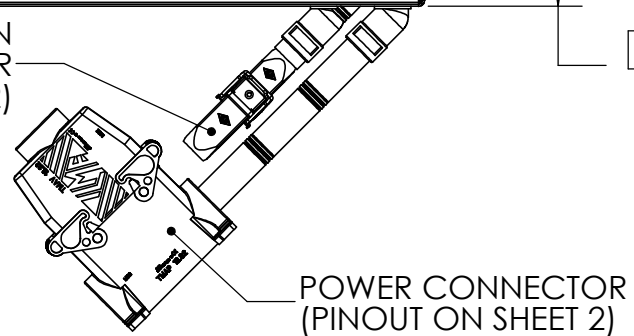
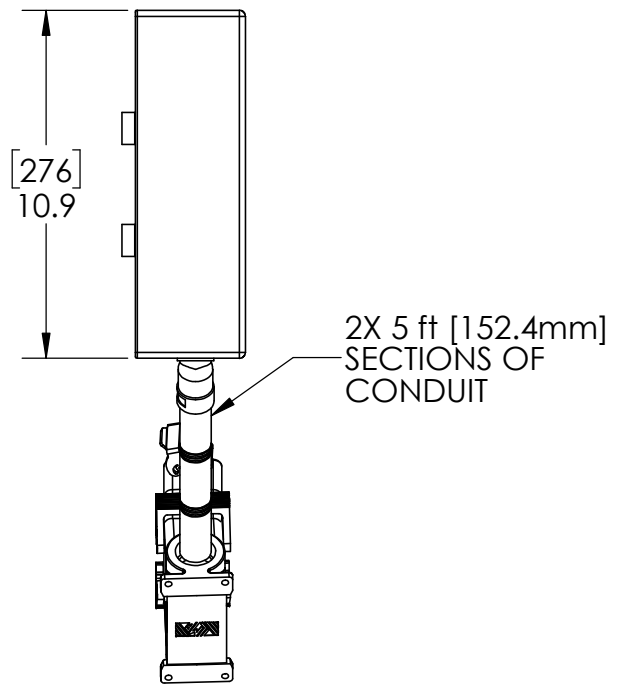
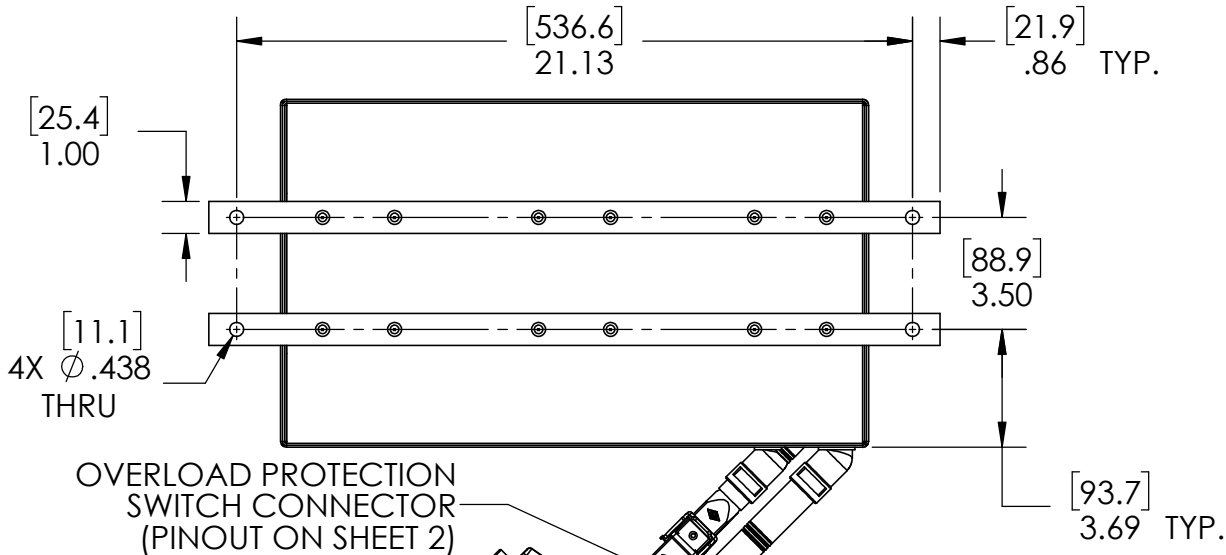
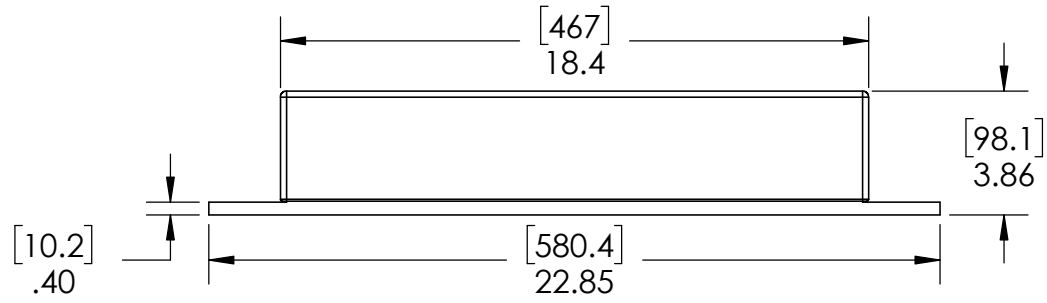

SPECIFICATIONS:

Description: 3 pole linear induction motor encapsulated in a stainless steel enclosure

Force: 225 lbs @ 360 ips.

Requirements: 3-Phase 400 VAC 100 A @ 75 Hz, 0.125" Aluminum, 0.25" Steel Minimum , 0.375" Minimum Air Gap.

Net Weight: approximately 49 kg (107 lbs)

Insulation, windings: Class H (180°C) Insulation, cables, resin: Class F (155°C)

Protection class: IP67 Thermal switch type: single pole normally closed thermal switch, automatic reset

Thermal switch trip temp.: 140°C

Thermal switch contact rating: 1.6A 250v 0.6p.f. 50/60Hz

Cables: Power leads are four 5 ft long #10 AWG conductors with 0.5" OD braided shielding and 5ft of 0.65" ID. Thermal leads are two 5ft long 22 AWG conductors in 5 ft of 0.65" ID PMA conduit.

POWER CONNECTOR

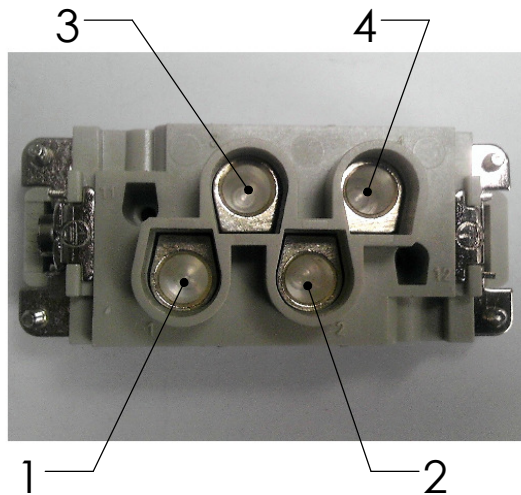

OVERLOAD PROTECTION SWITCH

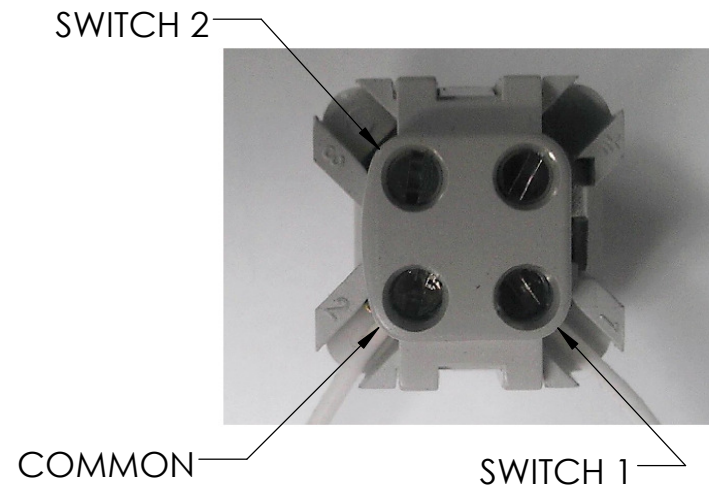

| PIN LAYOUT | | |
|------------|----------|-------|
| PIN | FUNCTION | COLOR |
| 1 | POWER | BLK |
| 2 | POWER | RED |
| 3 | POWER | WHT |
| 4 | POWER | GRN |